



CASTLEGAR

SAMPLE SITE PLAN

Site Plan Requirements

When do I Need to Submit a Site Plan?

A site plan is required when exterior work is proposed on a residential property. Typical work requiring the submittal of a site plan includes:

- Room additions, garage and carports additions
- Decks, patio enclosures, exterior covers and sheds
- Garage conversions
- Fences, retaining walls
- Site work involving installation of underground water/sewer lines
- Soil material being added or removed from a property.

Information on Site Plan

A site plan is an accurate, scaled drawing or map of a piece of property showing its size and shape. The site plan allows the property owner, the builder and the building inspector to verify the true location of any proposed structure(s); further, the site plan allows the Building Official to ascertain that any proposed new work is located within the setback requirements according to the Zoning Bylaw.

SITE PLAN (Sample Only)

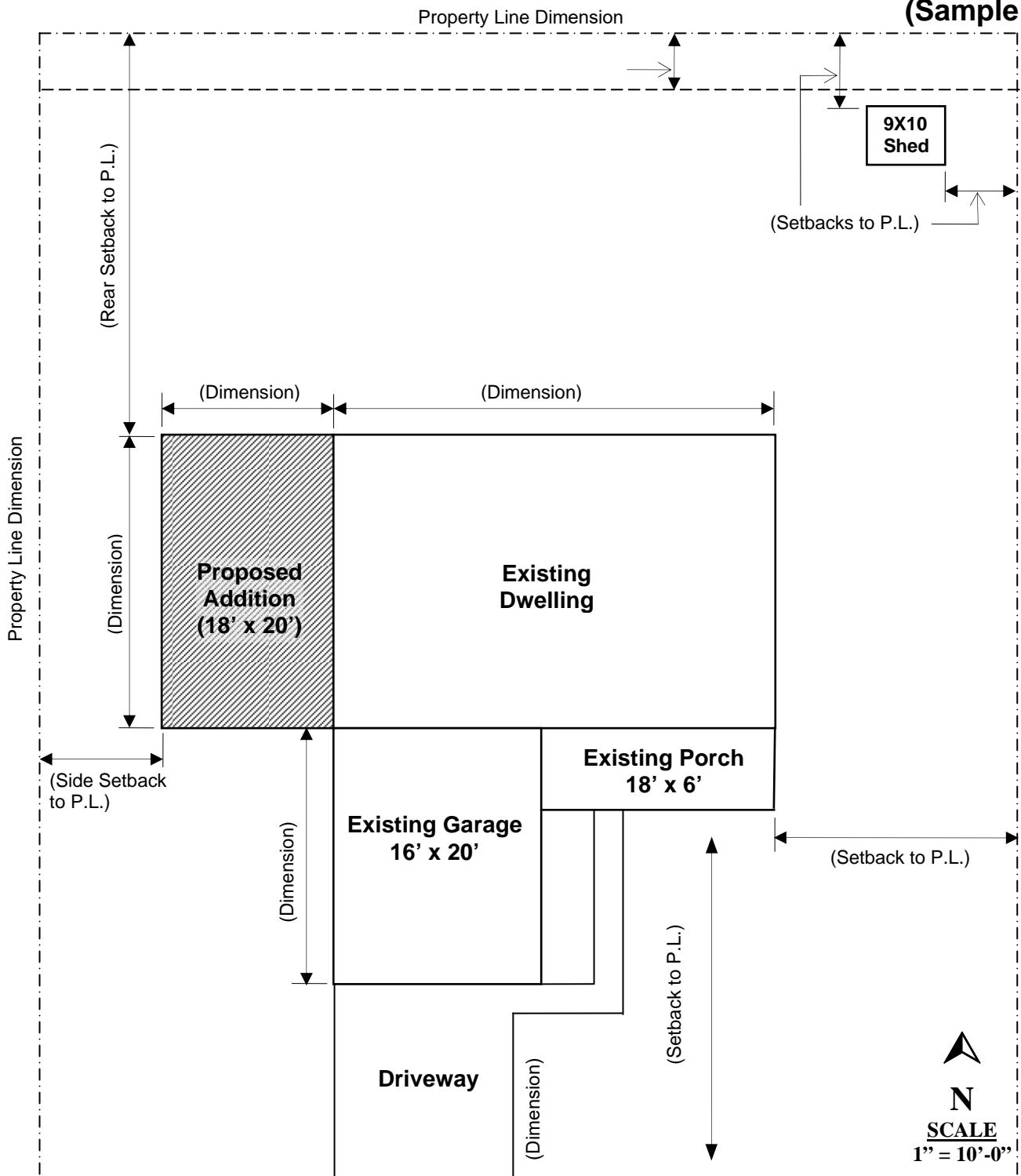

Street Name

Checklist:

1. Street name
2. Drawing scale, north arrow
3. Lot dimensions, property lines
4. Easements, utilities
5. Label and locate existing buildings and other physical structures
6. Label and locate proposed additions, retaining walls and other physical structures
7. Setback distances to property lines, easements and distances to other structures
8. Property owner name address and phone number